

# ANIGMO

## Touchless switch

Touchless switch with 10A relay output  
Model AE-2400 R

### Important notes

#### CAUTION:

1. Read and understand these instructions before installing device. Before installing this unit, disconnect power at circuit breaker or remove fuse to avoid shock or damage to the unit. This device is intended for installation with local regulations. It is recommended that a qualified electrician perform this operation
2. Do not install in combination with standard 3-Way switches or third party remote (slave) unit. Use only in combination with Anigmo AE-S remote (slave) unit.
3. Installation of this switch in proximity of strong EM interference such as (and not limited to) electrical welding machines, inadequately shielded power supplies, radars etc. could cause inadvertent switch activity.
4. This switch may not be used in any application in which the inadvertently changing the switch state could create a situation where personal injury, death or property damage may occur.
5. This unit requires a neutral connection
6. Do not exceed maximal rated current of the unit

### Warranty

All products sold or distributed by Anigmo or any of its subsidiaries are guaranteed to be free from defects in materials and workmanship for the period of 5 years. This warranty shall extend to the original end purchaser only. Anigmo, at its option, shall repair or replace any Anigmo product within the Terms of Warranty expressed herein, which fails to meet the product's specifications.

This warranty does not extend to product failures or defects caused by, or associated with, but not limited to; failure to install or maintain correctly, unsuitable physical or operating environment, accident, force majeure, hazard, misuse, electrical supply, unauthorised repair, modification or alteration.

Anigmo will not accept any liability or responsibility under the terms of warranty expressed herein for, but not limited to; negligence, loss of profit or data or damages either material or personal. Mandatory liability shall be restricted to the sum equal to the purchase of the product.

This product may be protected by following patents  
US 7.531.921, EP 2.038.906, US20090284182,  
US 8.339.062, EP 2.292.078

### Contact

ANIGMO  
Anigmoteh d.o.o.  
Tehnoloski park 21  
1000 Ljubjana  
Slovenia, Europe  
www.anigmo.com  
email: support@anigmo.com

### INSTALLATION

1. **WARNING:** Turn power OFF at circuit breaker or remove the fuse



2. Connect wires as shown. Refer to wiring diagrams.

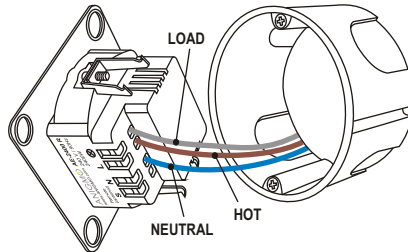

3. Before installing the unit into a wallbox, set the desired sensor range if needed.  
NOTE: The unit is supplied with its sensing range set to maximum ( about 10 cm).

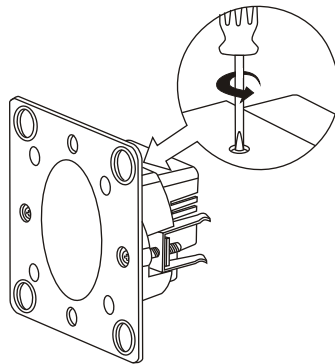

4. Mount the unit into wallbox using claws. Align before tightening the claw screws

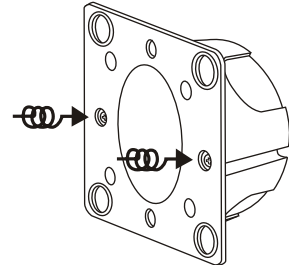
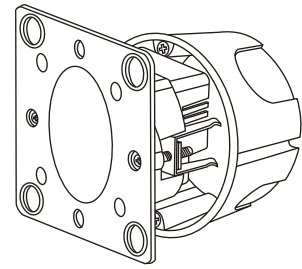

If mounting with screws, first remove both claws, complete with nuts and screws. Fix the unit with provided screws only.

5. Attach decorative switchplate. Align magnets on the back of the switchplate with magnets on the unit and push.

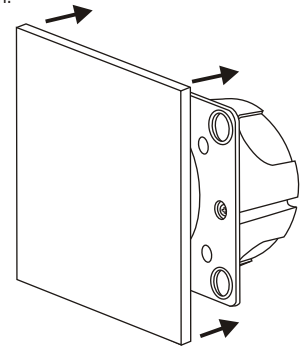

6. Restore power at the circuit breaker

### WIRING DIAGRAM

SINGLE LOCATION CONTROL (one switch controlling one load)

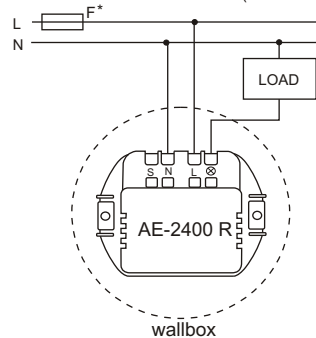

Load rating:  
240V AC / 50Hz  
10A max

\* Connect only to mains protected with fuse rated 10A or less.

MULTI LOCATION CONTROL (multiple switches controlling one load)

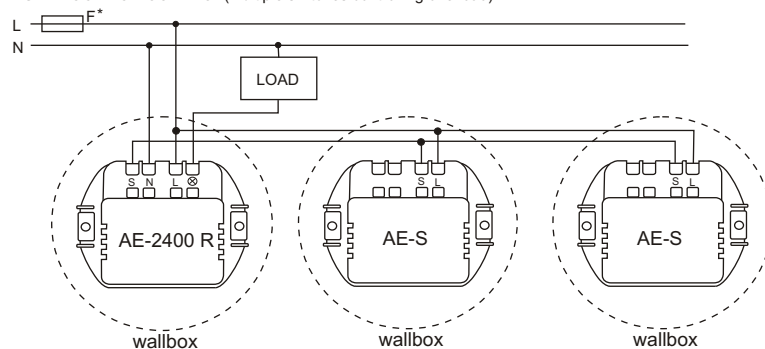

# AE-2400R TOUCHLESS SWITCH OPERATIONAL MANUAL

AE-2400R can switch various loads, including Incandescent, Halogen, Low voltage Halogen, LED, CFL and linear fluorescent lamps. When AE-2400R is connected and powered up, the lights can be turned on by moving the hand in front of the switch plate. When the hand enters the switch sensing range, the lights will turn on. The hand should then move out of the sensor range. When the hand enters the switch sensing range again, the lights will turn off. Each time the hand enters the sensing range, the switch will change its on/off state. If the hand remains inside of the switch sensing range, no switch state change will occur.

Switch plate can be removed and replaced at anytime, without first switching the power off at the fuse. But when removing the switch plate please note, that the switch will enter the calibration cycle whenever the switch plate is removed, attached or moved. The cycle will last for about 1-2 minutes during which the switch will be unresponsive.

NOTE: When the power is supplied to the switch, its state will always be in "off" position, regardless of its state when it was powered down.

## Turn the lights on and off:

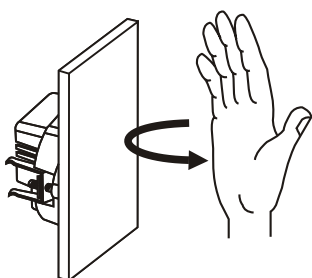

Whenever the hand enters the sensing range in front of the switchplate light turns on/off

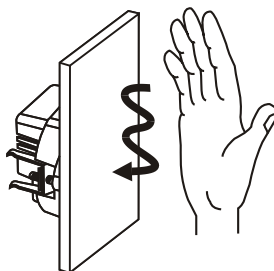

Moving the hand while staying in sensing range doesn't have any effect on the switch operation. To turn the switch on/off, the hand must first LEAVE the sensing range.

**Note:** Touchless switch with attached switchplate is depicted in above examples. The switch mechanism is visible in the images for clarity, but with typical installation it would be hidden inside the wallbox and only the switchplate would be visible on the wall surface.

## Troubleshooting

SYMPTOM	POSSIBLE CAUSE	SOLUTION
The light doesn't turn on	Faulty wiring	Check if the switch is connected according to the connection diagram. Check if the fuse is turned on after connecting
	Faulty light bulb	Check the lightbulb and replace if necessary.
The switch doesn't react to hand movement	Switch entered the calibration mode	If the switchplate is exchanged, moved, removed or re-attached, the switch automatically enters the calibration mode, during which it does not react on any hand movement. Wait for approx. 1-2 minutes for the dimmer to complete the cycle.
Switch operation is inconsistent (it doesn't react consistently to the hand movements)	Close proximity of moving objects	Switch sensor reacts to any moving object in the sensing range that is large enough. Check if any object close to the sensor can move into or close to the sensor range (such as: curtains, hanging wires, ropes or wall decoration).  Check if the switch plate is securely fixed. Moving switch plate even slightly can cause unreliable switch operation.
	Unshielded or poorly shielded transformers or power supplies near the switch, switch wiring or as a switch load.	Poorly shielded transformers, drivers and power supplies can cause excessive EMI (electromagnetic interference), that can cause unreliable switch operation. Use only certified and properly shielded power supplies.  Reduce sensing range to decrease sensibility
Difficult to switch the lights on	Connected light has a dead time before switching on	Some light sources, especially fluorescent lights have a significant delay between the moment the power is applied to them and the moment the light turns on. This delay can be several seconds in length. Due to this delay, no light will be emitted from the light source at the moment the user turns the switch on. User unfamiliar with this behaviour could falsely think that the switch didn't react to their "on" command and try to activate the switch again. But this second motion would in fact turn the switch off. To resolve this, turn the switch on and wait for couple of seconds. Listen to discrete click sound from inside of the switch, indicating the switch has actually turned on.  Alternatively, use the switch version with sound feedback option.