

ANIGMO

Touchless dimmer

Touchless dimmer with 300W output
Model AD-300

Important notes

CAUTION:

1. Read and understand these instructions before installing the device. Before installing this unit, disconnect power at the circuit breaker or remove fuse to avoid shock or damage to the unit. This device is intended for installation with local regulations. It is recommended that a qualified electrician perform this operation
2. Do not install in combination with standard 3-Way switches or third-party remote (slave) unit. Use only in combination with Anigmo AE-S remote (slave) unit.
3. Installation of this switch in the proximity of strong EM interference such as (and not limited to) electrical welding machines, inadequately shielded power supplies, radars, etc. could cause inadvertent switch activity.
4. This switch may not be used in any application in which the inadvertently changing the switch state could create a situation where personal injury, death or property damage may occur.
5. This unit requires a neutral connection
6. Do not exceed the maximal rated current of the unit

Warranty

All products sold or distributed by Anigmo or any of its subsidiaries are guaranteed to be free from defects in materials and workmanship for the period of 5 years. This warranty shall extend to the original end purchaser only. Anigmo, at its option, shall repair or replace any Anigmo product within the Terms of Warranty expressed herein, which fails to meet the product's specifications.

This warranty does not extend to product failures or defects caused by, or associated with, but not limited to; failure to install or maintain correctly, unsuitable physical or operating environment, accident, force majeure, hazard, misuse, electrical supply, unauthorised repair, modification or alteration.

Anigmo will not accept any liability or responsibility under the terms of warranty expressed herein for, but not limited to; negligence, loss of profit or data or damages either material or personal. Mandatory liability shall be restricted to the sum equal to the purchase of the product.

This product may be protected by following patents
US 7.531.921, EP 2.038.906, US20090284182,
US 8.339.062, EP 2.292.078

Load Rating

	Mode 1	Mode 2
Max. load	300W 120W for LED, CFL	300W
Min. load	0W	40W*
Load type	LED, CFL, incandescent, halogen, Low voltage halogen (electronic)	incandescent, halogen, Low voltage halogen (magnetic)
Neutral wire	Connect Neutral wire	Do not connect Neutral wire

* Minimum load in multi-location connection should be increased by 20W for each AE-S unit

INSTALLATION

1. **WARNING:** Turn power OFF at circuit breaker or remove the fuse



2. Connect wires as shown. Refer to wiring diagrams.

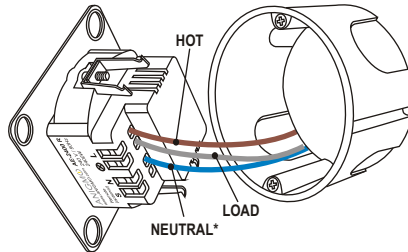

* Neutral lead connected only in Mode 1

3. Before installing the unit into a wall box, set the desired sensor range if needed.
NOTE: The unit is supplied with its sensing range set to maximum (about 10 cm).

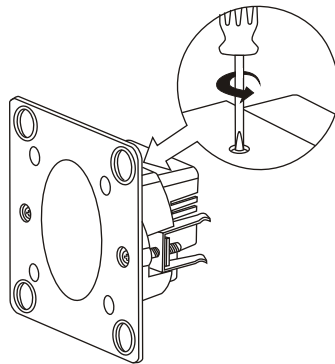

4. Mount the unit into wall box. Align before tightening the fixing screws

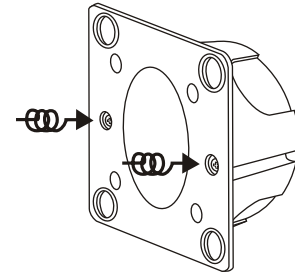
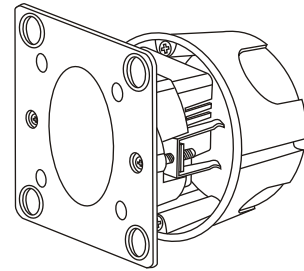

5. Attach decorative switchplate. Align magnets on the back of the switchplate with magnets on the unit and push.

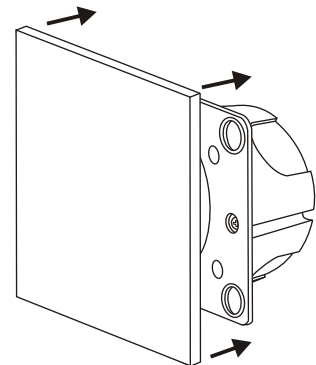

6. Restore power at the circuit breaker

WIRING DIAGRAM

Dimmer operational mode (MODE1 or MODE2) is selected by appropriate connection

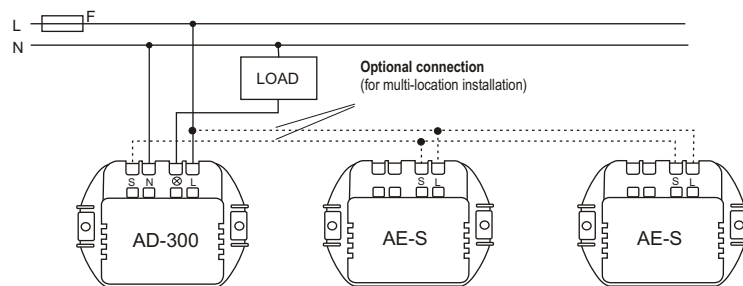

MODE 1 (connection with neutral wire)

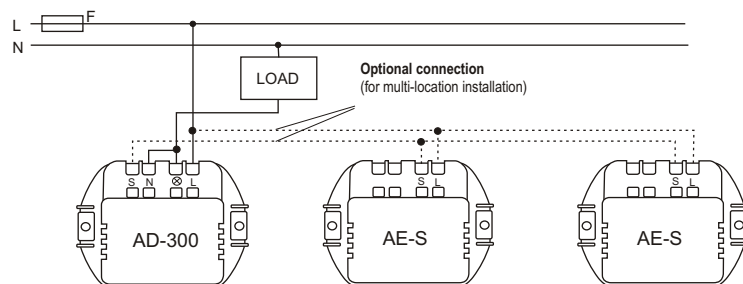

MODE 2 (connection without neutral wire)

AD-300 TOUCHLESS DIMMER OPERATIONAL MANUAL

AD-300 can switch and dim various loads, including Incandescent, Halogen, Low voltage Halogen, dimmable LED, and CFL lamps. Please make sure that proper connection Mode is selected for specific load used.

When AD-300 is connected and powered up, the lights can be turned on by moving the hand in front of the switch plate. When the hand enters the dimmer sensing range, the dimmer will switch the lights on and set the brightness to the last selected level.

To change the brightness level of the lights, move the hand in front of the switch plate (into the dimmer sensing range) and hold it there for more than 1s. After 1s delay, the output brightness will start to decrease. The light intensity will decrease until it reaches minimum brightness or until the hand leaves the sensing range. When desired brightness level is reached, remove the hand. If an opposite direction of dimming is needed, move the hand outside of sensor range for a short period of time and enter it again, staying in the range for longer than 1s. Now the light intensity will slowly increase until it reaches maximum brightness or until the object leaves the sensing range.

To turn the lights off, move the hand in front of the dimmer sensing range for a period shorter than 1s.

Turn the lights on and off:

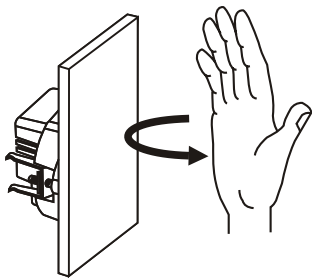

Whenever the hand enters the sensing range in front of the switchplate for period shorter than 1s, the light turns on/off

Changing the light brightness (dimming):

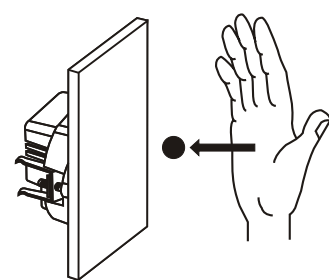

Whenever the hand enters the sensing range in front of the switch plate and is held there for more than 1s, the light output slowly decreases until it reaches minimum brightness or until the hand leaves the sensing range.

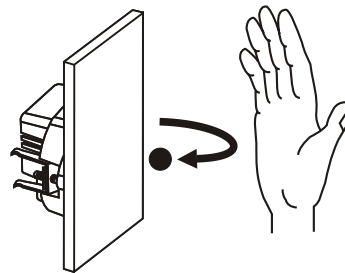

To change the dimming direction, the hand should leave the range for a short period of time and enter it again, staying in the range for longer than 1s.

Note: A touchless dimmer with an attached switchplate is depicted in the above examples. The dimmer mechanism is visible in the images for clarity but with typical installation it would be hidden inside the wall box and only the switchplate would be visible on the wall surface.

Troubleshooting

SYMPTOM	POSSIBLE CAUSE	SOLUTION
The light doesn't turn on	Faulty wiring	Check if the dimmer is connected according to the connection diagram. Check if the fuse is turned on after connecting
	Faulty light bulb	Check the lightbulb and replace it if necessary.
The dimmer doesn't react to hand movement	Dimmer entered the calibration mode	If the switch plate is exchanged, moved, removed, or re-attached, the dimmer automatically enters the calibration mode, during which it does not react to any hand movement. Wait for approx. 1-2 minutes for the dimmer to complete the cycle.
	Wrong connection mode	LED and CFL lamps should only be used when the dimmer is connected in Mode 1
Dimmer operation is inconsistent (it doesn't react consistently to the hand movements)	Close proximity of moving objects	The dimmer sensor reacts to any moving object in the sensing range that is large enough. Check if any object close to the sensor can move into or close to the sensor range (such as curtains, hanging wires, ropes or wall decoration) Check if the switch plate is securely fixed. Moving the switch plate even slightly can cause unreliable dimmer operation.
	Unshielded or poorly shielded transformers or power supplies near the dimmer, dimmer wiring, or as a dimmer load.	Poorly shielded transformers, drivers, and power supplies can cause excessive EMI (electromagnetic interference), that can cause unreliable dimmer operation. Use only certified and properly shielded power supplies. Reduce sensing range to decrease sensibility
Light can't turn fully off	Wrong connection mode	Light sources that can start to produce light with very low power (such as LED and CFL lights) can't be turned fully off in connection Mode 2. Use connection Mode 1 instead.